

Cleaning the Ink Head and the Area around It

The heads and their surroundings are the parts most liable to be tainted in this machine and if tainted, it could cause adverse effects to the functions of the machine and the results of the printings. Moreover, as the head itself uses very fine mechanisms, sufficient precautions are required for the care and maintenances.



- Use the cleaning stick (SPC-0527) or nozzle swab (SPC-0421) for cleaning around the ink head. Using the other cotton bud may attach lint, then it may damage the machine.
- Also clean the underside of the carriage so that it will not get dirty due to ink or dust. If you leave it dirty, dirt may adhere to the nozzle surface, or, dust and dry ink may be rubbed against the nozzle.
- Also perform maintenance on the ink caps and wipers at the capping station. If you leave it dirty, dust and dry ink may be rubbed against the nozzle at wiping operation when performing head cleaning.
- Using a cleaning swab, etc., rub off gelatinous ink or dust that may stick to the lower part of the slider and the area around the ink head. In doing so, never rub the nozzles of the head.
- If you use LUS-120 ink, you cannot use the UJ cleaning swab.

Tools required for cleaning		
• F-200 / LF-200 Washing Liquid (SPC-0568)		
• Clean stick (SPC-0527)		
• Nozzle swab (SCP-0421)		
• UJ Cleaning swab (SPC-0386)		
• MAINTENANCE CLOTH (SPC-0574)		
• Gloves	• Safety glasses	• Hand mirror



- Be sure to wear the attached safety glasses and gloves when cleaning the area around the ink head. Otherwise, you may get ink in your eyes.
- The ink contains organic solvent. If you get the ink on your skin or in your eyes, wash it away with plenty of water immediately.

1 Press the **FUNC1** (MENU) \rightarrow **▼** (4 times) \rightarrow **ENTER** key in LOCAL.
 • MAINTENANCE MENU will be displayed.

2 Press the **ENTER** key.
 • “STATION” will be displayed.

3 Press the **ENTER** key, and press **▲** **▼** to select “left end” or “center”.

4 Press the **ENTER** key.
 • The carriage will move. (In the case of UJF-7151 plus, the carriage will move to the left end, and in the case of UJF-7151 plusII, the carriage will move to the center when selecting the center.)
 • The table will be moved to its lowest point. (7151 PlusII only)

5 Open the cover.

- For maintenance on the left end of the machine, open the left front cover and H maintenance cover.
- For maintenance on the center of the machine, open the front cover.

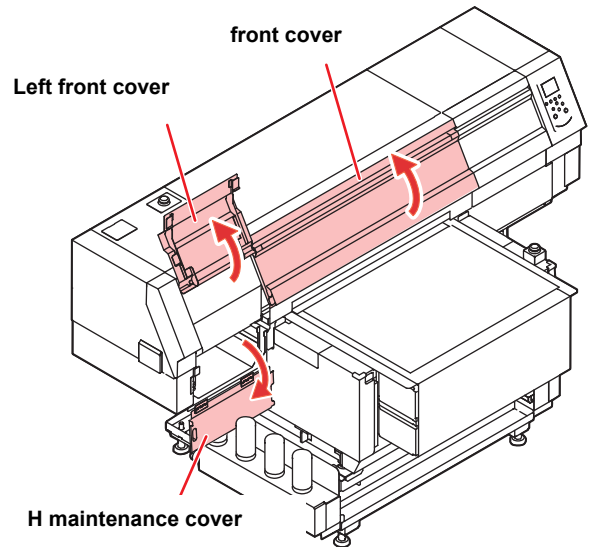

6 Wipe ink sticking to the side of the head off with a cleaning stick.

- Soak the cleaning stick in the maintenance cleaning liquid and wipe off an accumulated ink on the around of the nozzle surface, on the side of the head and on the bottom surface of the slider.
- Never rub the nozzles.

Maintenance on the left end of the machine

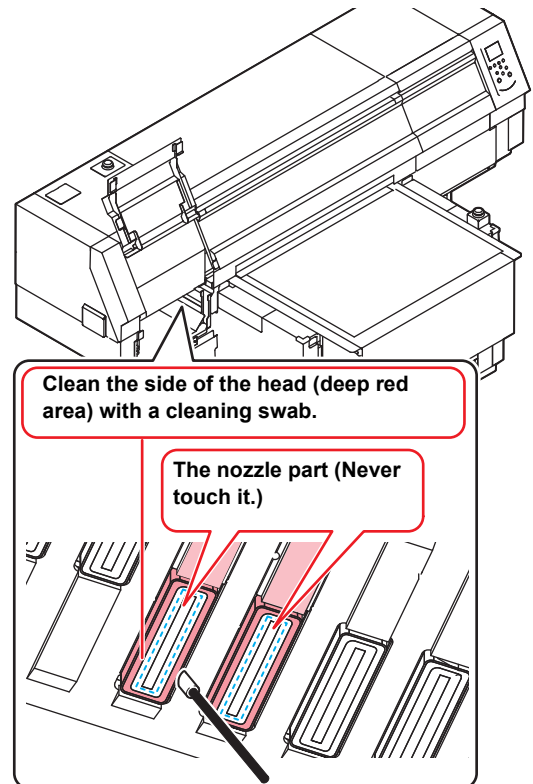

Clean with cleaning stick.

Maintenance on the center of the machine

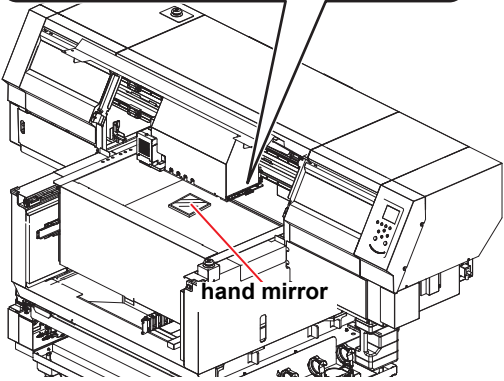
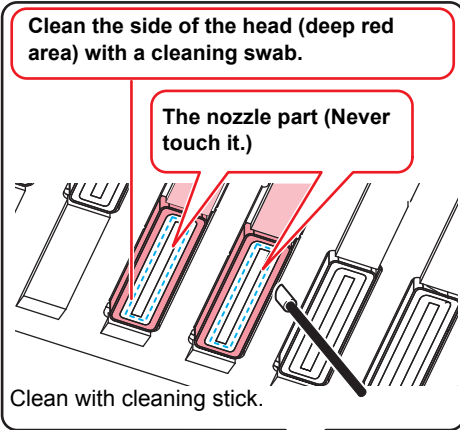

Put a hand mirror on the table and work while looking in the mirror.



Ⓞ In the case of UJF-7151PlusII, the carriage can be moved by hand while the cover is open. Move it to a position that is easy to work with and clean it.

- Wipe off the ink which attached to the black part and the gap around the head.

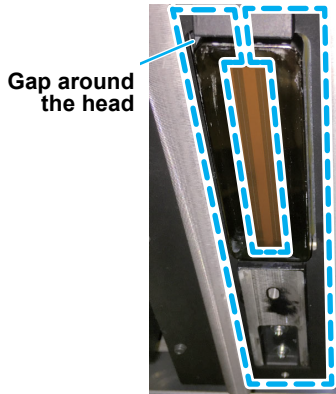
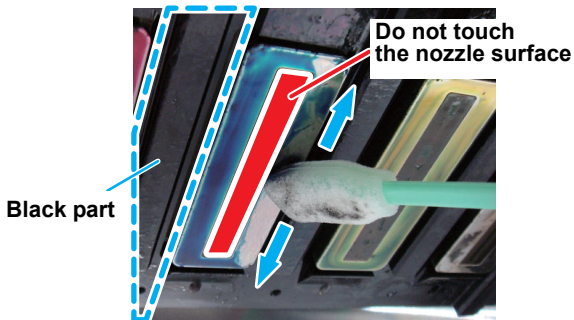

7

Press the **ENTER** key after the cleaning.

8

Close the cover, and press the **ENTER** key.

- After its initial operation, the machine returns to step 2.



- When you leave during maintenance, please make sure to complete the cleaning by pressing the [ENTER] key. Without completing the cleaning, the nozzle part is left uncovered and then outside light makes the ink cure, which causes nozzle clogging or the like.