

Filling with Antifreeze Mixed Water

Refill the hot-water circulation tank in the head with antifreeze mixed liquid.

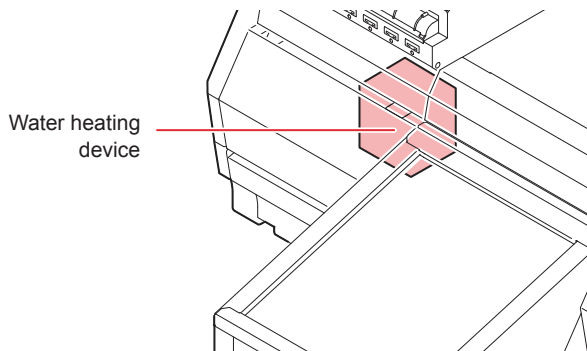

Note on refill



- When only water is supplied to the cooling water tank without antifreeze liquid, the water heating unit or head may be damaged due to freezing.
- When only antifreeze liquid is supplied to the cooling water tank without water, the machine does not work properly, and may cause an error.
- If water in the cooling water tank frequently becomes insufficient, contact your local distributor, our sales office, or service center.



- Dispose of the waste water mixed with antifreeze liquid pursuant to the regulations of your district.

Note on antifreeze mixed liquid



To make mixed liquid, be sure to use the potable water meeting one of the following conditions:

- Calcium content:
 - 1 mg/100 ml (10 mg/L) or less
 - Hardness : 60 mg/L or less
 - Distilled water (Purified water)
- Water and antifreeze liquid compound ratio should be 2(water) to 1(Antifreeze liquid).
Or use our specialized antifreeze mixed liquid.
- Use it within one week when you make mixed liquid. The mixed liquid that one week or more passed after it makes it is never used for this machine regardless of use/unused. Moreover, do not add to the mixed liquid newly made.

Precautions in handling the antifreeze liquid



- Be sure to wear the included safety glasses and gloves for handling the antifreeze liquid.



- Use the recommended antifreeze liquid by Mimaki. If not, the cooling device may be broken. (Supplied antifreeze liquid : 1000cc x 2 bottles)
- Do not touch the antifreeze liquid directly. If the antifreeze liquid settles on your skin or clothes, immediately wash it off with soap and water. If you get antifreeze liquid in your eyes, immediately wash your eyes with a lot of clean water. Then, consult a doctor as soon as possible.
- Store antifreeze liquid in a dark and cold place.
- Store antifreeze liquid in a place that is out of the reach of children.
- When discarding antifreeze liquid which is no longer needed, entrust them to an industrial waste disposal contractor, clarifying their contents.
- Before using antifreeze liquid, be sure to read the Safety Data Sheet (SDS).



- Prepare a tank with a cap to put in the waste water from cooling water tank.
- When water in the cooling water tank is low, a warning message "WATER LACK" is displayed. In this case, refill antifreeze water in the way shown as the next page.

Supplying antifreeze liquid

If an error of lack of water occurs, supply antifreeze mixed water.

1

Press the **(FUNC1)** (MENU) in LOCAL mode.

2

Press **(▲)** **(▼)** to select "Maintenance", and press the **(ENTER)** key.

- MAINTENANCE MENU will be displayed.

3

Press **(▲)** **(▼)** to select "Water FillUp", and press the **(ENTER)** key.

4

Press the **(ENTER)** key.

- Water flow stops.

5

Open the left maintenance cover.

6 Disconnect the right end of the tube connected to the feed-water inlet.

- Indicated with "IN" label.

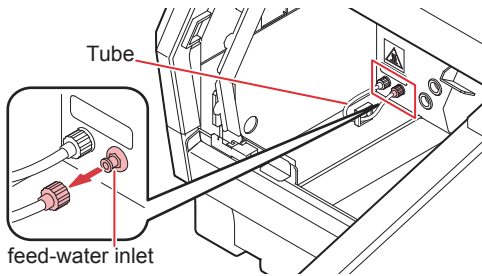

Important!

- Pay attention while handling the tube as antifreeze liquid flowing in it is hot.
- Make sure that water flow has stopped in Step 2.

7 Made mixed liquid (antifreeze liquid: 1, water: 2) in the attached reservoir and move it to the attached syringe.

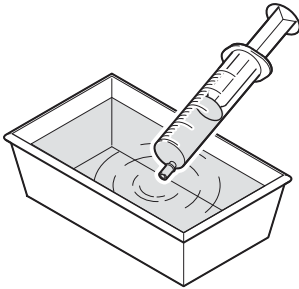

8 Refill antifreeze mixed liquid.

- For using a 50 cc syringe

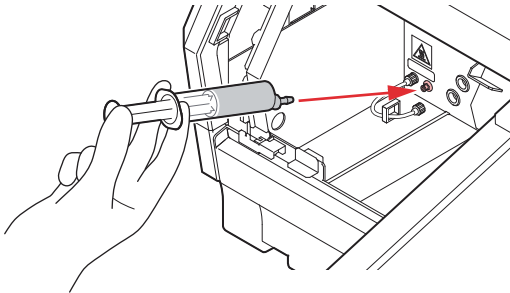

- Inject the antifreeze mixed liquid, which is prepared in Step5, from the feed-water inlet.
- Injection water slowly until the buzzer sounds.

- For using a 100 cc syringe

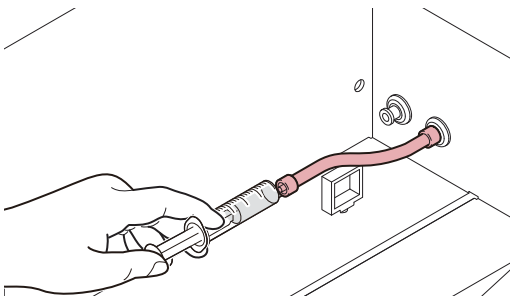

- Connect the tubing removed in step 6 to the syringe and water supply port and inject.
- Injection water slowly until the buzzer sounds.

9 When the buzzer sounds, stop refilling and, press the **ENTER** key.

- "To 200cc filling" will be displayed.

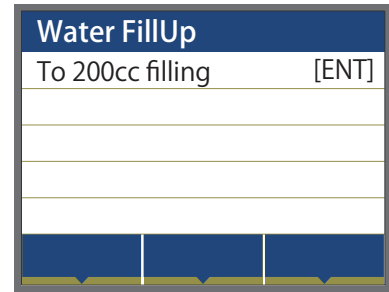

10 Supply 200cc of the liquid.

- "Tie an infusion mouth" will be displayed.

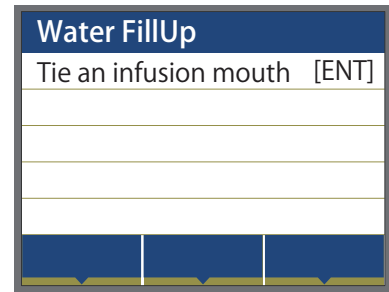

11 Connect the tube to the feed-water inlet.

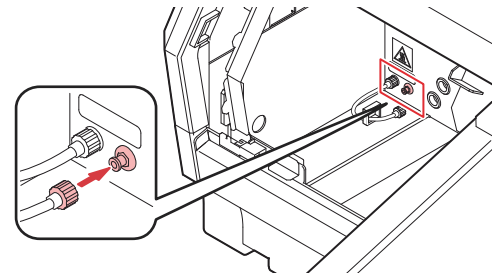

- After connecting the tube, make sure they are not twisted. If it is twisted, the water flow will stop there and "WATER TANK ROUTE" error may occur.

12 Press the **ENTER** key.



- If press the [Enter] key without connecting the tube to the feed-water inlet, the mixed liquid will be overflowing.